

Report to Facilities Planning Commission

October 26, 2023

John A. Harman, MBA, CGMA, CMPE | VP Finance & Administration

Introductions and Review of Committee Charter

Council Responsibilities:

1. Recommend to the President the priority for building construction, remodeling, and optimal building utilization during master planning efforts.
2. Advise on major changes in the use of space.
3. Review requests for additional space and equipment, which would become a part of the building inventory.

FACILITIES PLANNING COMMISSION / 10.24.2023



Oregon Tech's - Capital Projects Update

Thom Darrah | Director of Facilities & Capital Planning

Presentation Outline

Capital Projects – Upcoming and Underway

- New Student Housing
- Geothermal Systems Emergency Renovation
- Boivin Hall Traffic Improvements
- DPT Research Lab Renovation
- ABA Clinic Renovation



New Student Housing

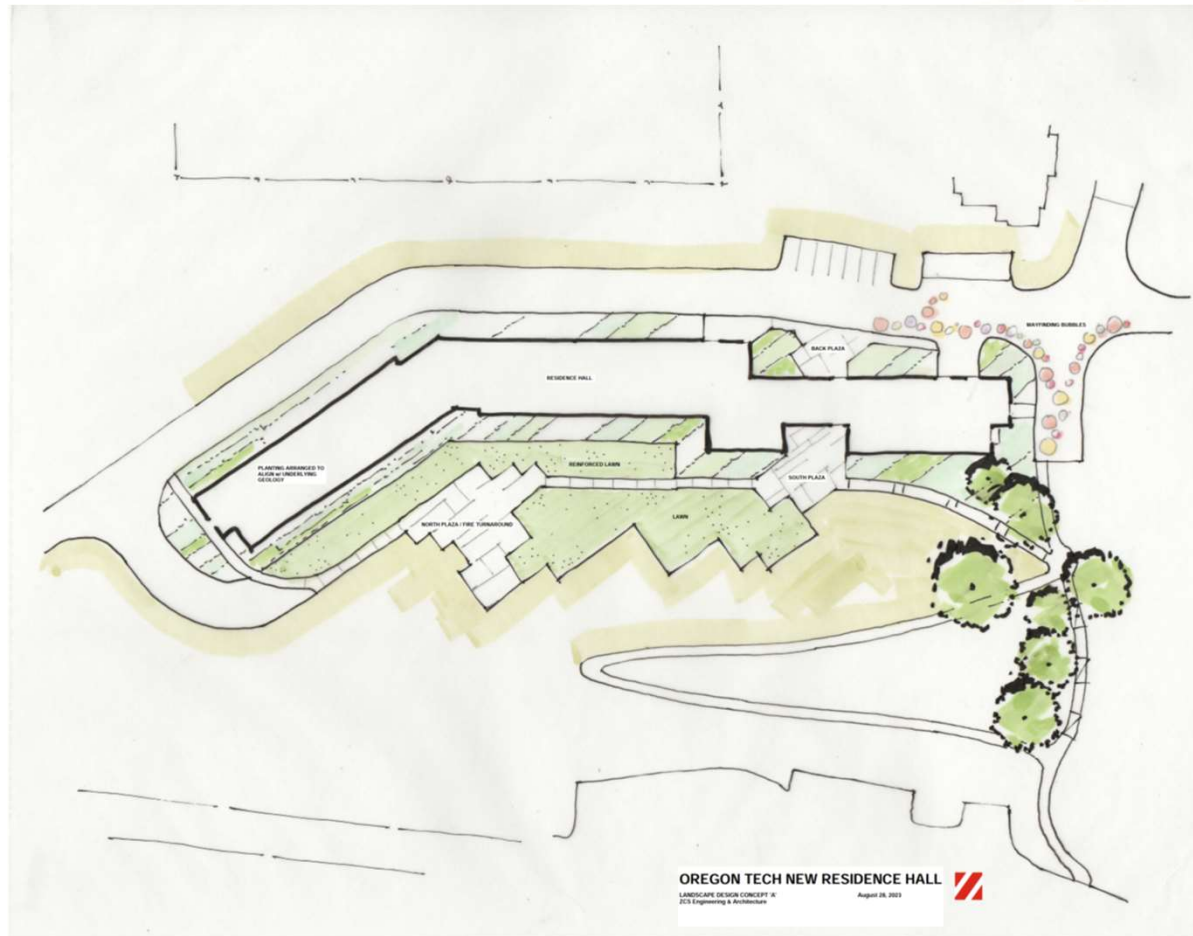

New Student Housing



Oregon TECH

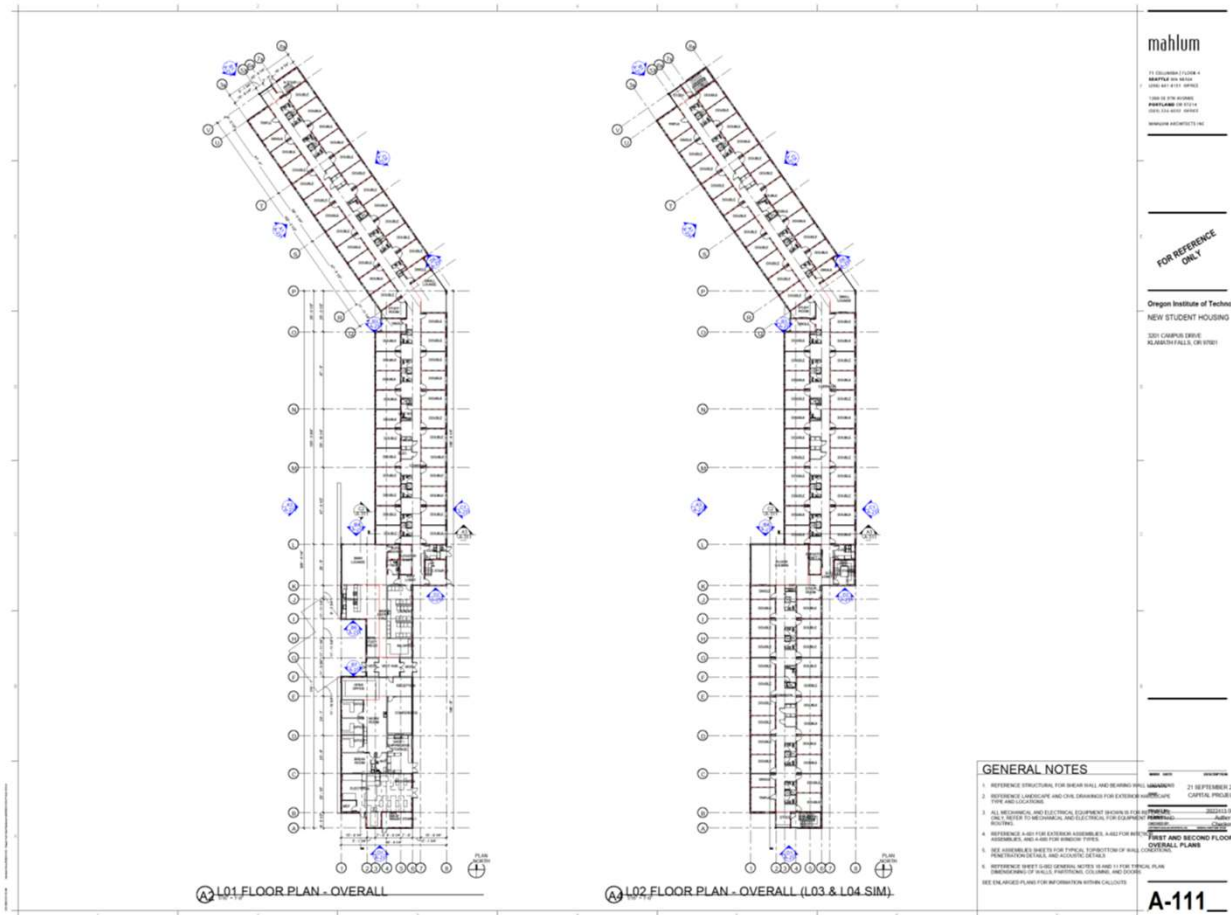

New Student Housing



New Student Housing



Boivin Hall Traffic Improvements



Boivin Hall Traffic Improvements										
Project Start: 5.01.24				Project Completion: 8.31.24						
Project	Progress Highlights				Cost Breakdown	Orig. Budget	Rev. Budget	Cost To Date	%	Balance
UPE	Design: Underway									
UPE	Construction: May 2024 - Aug. 2024									
	Project underway.				Design (5%):	\$ 85,400	\$ 85,400	\$ 13,400	16%	\$ 72,000
					Construction (85%):	\$ 1,714,600	\$ 1,714,600	\$ -	0%	\$ 1,714,600
					Other (10%):	\$ 200,000	\$ 200,000	\$ -	0%	\$ 200,000
Design: ZCS										
Build: TBD	Plan	Design	Bid	Build	Closeout	Project Totals:				
						\$ 2,000,000	\$ 2,000,000	\$ 13,400	1%	\$ 1,986,600
Budget Breakdown					<u>CO's / Amendments</u>			Percent Complete (%)		
					Total: \$ -					

Bovin Hall Traffic Improvements



OREGON TECH INDUSTRIAL PARK DRIVE IMPROVEMENTS

GENERAL INFORMATION

APPLICATOR/OWNER: OREGON INSTITUTE OF TECHNOLOGY
 CONTACT: TONY GIBNEY
 100 CAMPUS DRIVE
 CLATSOP COUNTY, OR 97131
 (503) 866-1000

ENGINEER: ZCS ENGINEERS ARCHITECTS
 CONTACT: MARK BENTLEY
 2001 CAMPUS DRIVE
 CLATSOP COUNTY, OREGON 97131
 (503) 866-1000

SITE LOCATION: INDUSTRIAL PARK DRIVE & 54th STREET
 CLATSOP COUNTY, OREGON

TAX LOT: 306
LOT SIZE: 1/4 ACRES
AREA OF IMPACT: 41.75 MINIMUM
ZONING: GC - GENERAL COMMERCIAL

SHEET INDEX

010 OVERALL ROADWAY PLAN AND TYPICAL SECTION
 ROADWAY LAYOUT SOUTH SIDE NORTH

CIVIL LEGEND

- | | |
|--|--|
| PAVEMENT & LANE LINES
NEW CONCRETE PAVING
NEW IMPRESSED SEEM REMOVAL AREA
NEW ASPHALT PAVING
NEW GRAVEL/GRASS
EXISTING DRAINAGE SWALE
NEW DRAINAGE SWALE
EXISTING EASEMENT
EXISTING DATA
EXISTING BIOCHEMICAL
EXISTING STORM SEWER
EXISTING NATIONAL GAS
EXISTING WATER POTABLE
EXISTING SANITARY SEWER GRAVITY
NEW POWER BURIED
NEW STORM SEWER | STREETS & DRIVEWAYS
SANITARY SEWER MANHOLE
STORM DRAIN MANHOLE
CATCH BASIN
CATCH VALVE
POWER VAULT
TELEPHONE/COMMUNICATIONS POWER POLE
STORM
STREETS & DRIVEWAYS
STORM DRAIN MANHOLE
CATCH INLET
TYPE 2 INLET
LIGHTING JUNCTION BOX
SINGLE CORE AND LEAD BELL AND CHAIN |
|--|--|

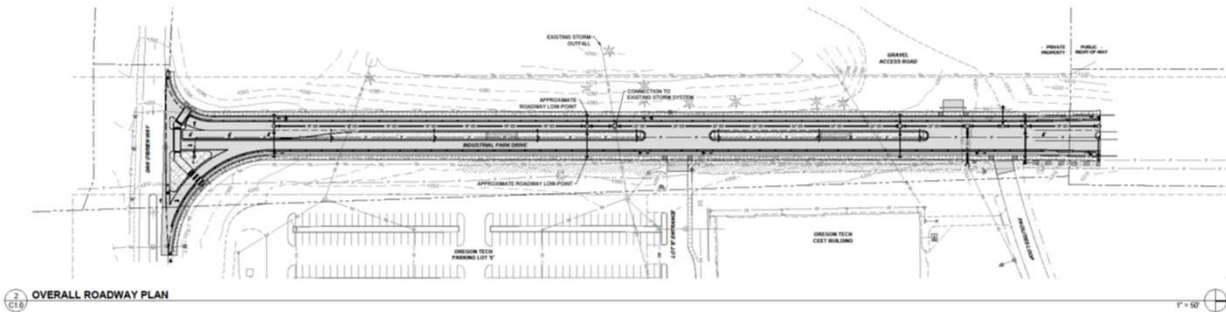

010 OVERALL ROADWAY PLAN

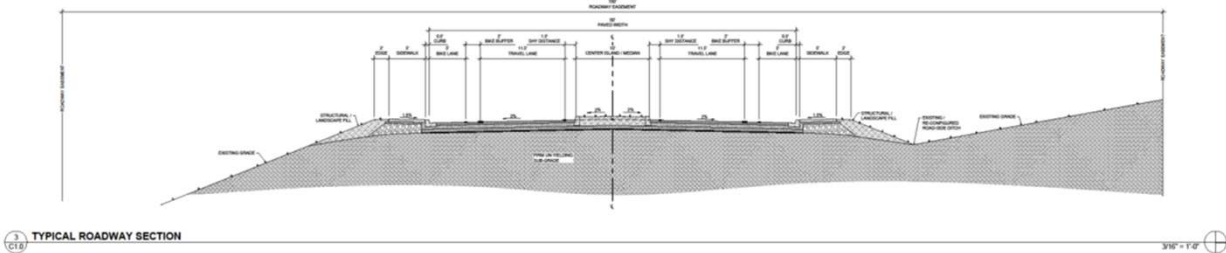

010 TYPICAL ROADWAY SECTION



OREGON TECH INDUSTRIAL PARK DRIVE IMPROVEMENTS

PROFESSIONAL SEAL
 NOT FOR CONSTRUCTION
 OREGON ENGINEERING BOARD
 REGISTERED PROFESSIONAL ENGINEER
 NO. 12345

REVISION NO.	DATE

PROJECT NO. 2024-01
 DRAWN BY: M.B.
 CHECKED BY: M.B.
 DATE: 10/20/24
 SCALE: AS SHOWN
OVERALL ROADWAY PLAN AND TYPICAL SECTION
C1.0

FOR AGENCY REVIEW (NOT FOR CONSTRUCTION)

DPT Research Lab Renovation



DPT Research Lab Renovation (1,000 sq ft)														
Project Start: 9.01.23				Project Completion: 12.31.23										
Project	Progress Highlights		Cost Breakdown	Orig. Budget	Rev. Budget	Cost To Date	%	Balance						
DPT430-DPT-FDN Gifts	Design: 100% Complete Construction: Sept. 2023 - Dec. 2023													
	Project underway.		Design (13%):	\$ 35,205	\$ 35,205	\$ 22,580	64%	\$ 12,625						
			Construction (78%):	\$ 212,894	\$ 212,894	\$ -	0%	\$ 212,894						
			Other (9%):	\$ 24,811	\$ 24,811	\$ 558	2%	\$ 24,253						
Design: ORW			Project Totals:	\$ 272,910	\$ 272,910	\$ 23,138	8%	\$ 249,772						
Build: DCI	Plan	Design	Bid	Build	Closeout									
Budget Breakdown			<u>CO's / Amendments</u>			Percent Complete (%)								
			<table border="1"> <tr><td> </td><td>\$</td><td>-</td></tr> <tr><td>Total:</td><td>\$</td><td>-</td></tr> </table>				\$	-	Total:	\$	-			
	\$	-												
Total:	\$	-												

DPT Research Lab Renovation

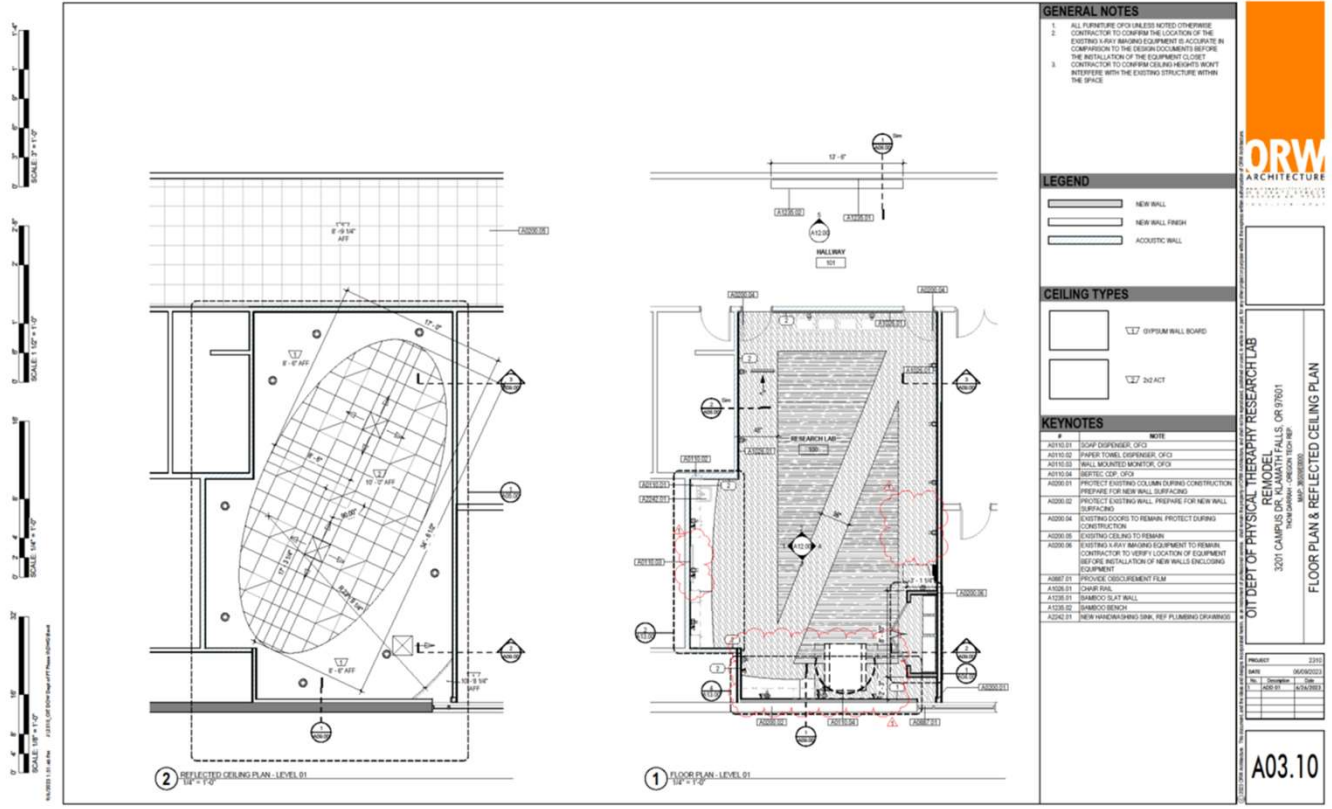

Geothermal Systems Emergency Renovation



Geothermal Systems Emergency Renovation										
Project Start: 11.06.23				Project Completion: 11.14.2026						
Project	Progress Highlights		Cost Breakdown	Orig. Budget	Rev. Budget	Cost To Date	%	Balance		
UPE: TBD	Design: TBD									
	Construction: TBD									
	Project underway.		Design (10%):	\$ 1,795,615	\$ 1,795,615	\$ 90,848	5%	\$ 1,704,767		
			Construction (75%):	\$ 13,467,116	\$ 13,467,116	\$ -	0%	\$ 13,467,116		
Design: AES			Other (15%):	\$ 2,693,420	\$ 2,693,420	\$ -	0%	\$ 2,693,420		
Build: TBD	Plan	Design	Bid	Build	Closeout	Project Totals:				
						\$ 17,956,151	\$ 17,956,151	\$ 90,848	1%	\$ 17,865,303
Budget Breakdown 			<u>CO's / Amendments</u> \$ - Total: \$ -		Percent Complete (%) 					



Covers
997,000gsf
and 17
buildings on
campus

O
R
E
G
O
N

T
E
C
H

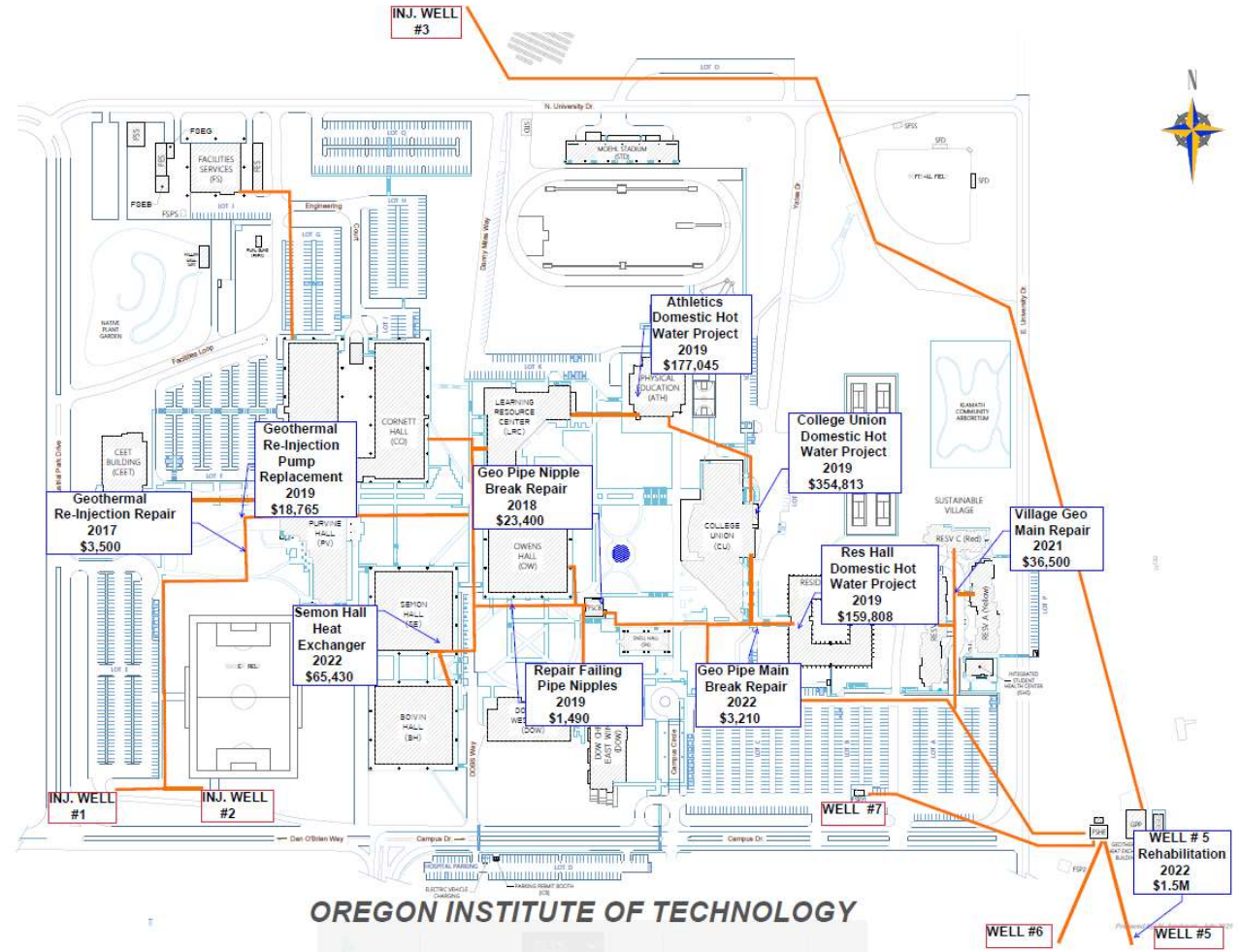

Geothermal Systems Renovation Update

	<u>2022 Dollars</u>	<u>Project Period Dollars</u>
Total:	\$ 14,951,000	\$ 17,956,151
Project Components:		
Production & Injection Wells	\$ 2,553,000	\$ 3,066,153
Geothermal Mechanical Building and Main Geothermal Storage and Pumping System	2,235,000	2,684,235
Geothermal Distribution System	5,382,000	6,463,782
Building Heat Exchange System	1,152,000	1,383,552
Geothermal System - Campus Snowmelt System	1,697,000	2,038,097
Geothermal System - Campus Main Electrical Equipment	1,932,000	2,320,332
	<u>\$ 14,951,000</u>	<u>\$ 17,956,151</u>
Project Period Dollars, Estimated Increase from July 2022		<u>20.10%</u>

Facilities Master Plan Recommendations

- Renovate the LRC and incorporate student services center
- Renovate Purvine Hall as a Dental Program center
- Renovate Semon Hall
- Develop New Seating and Restrooms for the Soccer Field
- Locate New Building at Campus Circle
- Reconfigure and Repair Parking Lot A
- Renovate the College Union
- Provide Outdoor Elevator to Connect Upper/Lower Campus
- Repair and Refresh the Geothermal Power Plant
- Provide a Field House Adjacent to the Athletics Building
- Provide New Storage Building for Facilities
- Provide New Greenhouse and Field Station
- Provide New Housing at PM Campus
- Refresh Residence Hall at KF Campus
- Develop Apartments and Academic buildings West of Industrial Drive
- Develop and Events Center on Campus Drive
- Campus Entry Signage

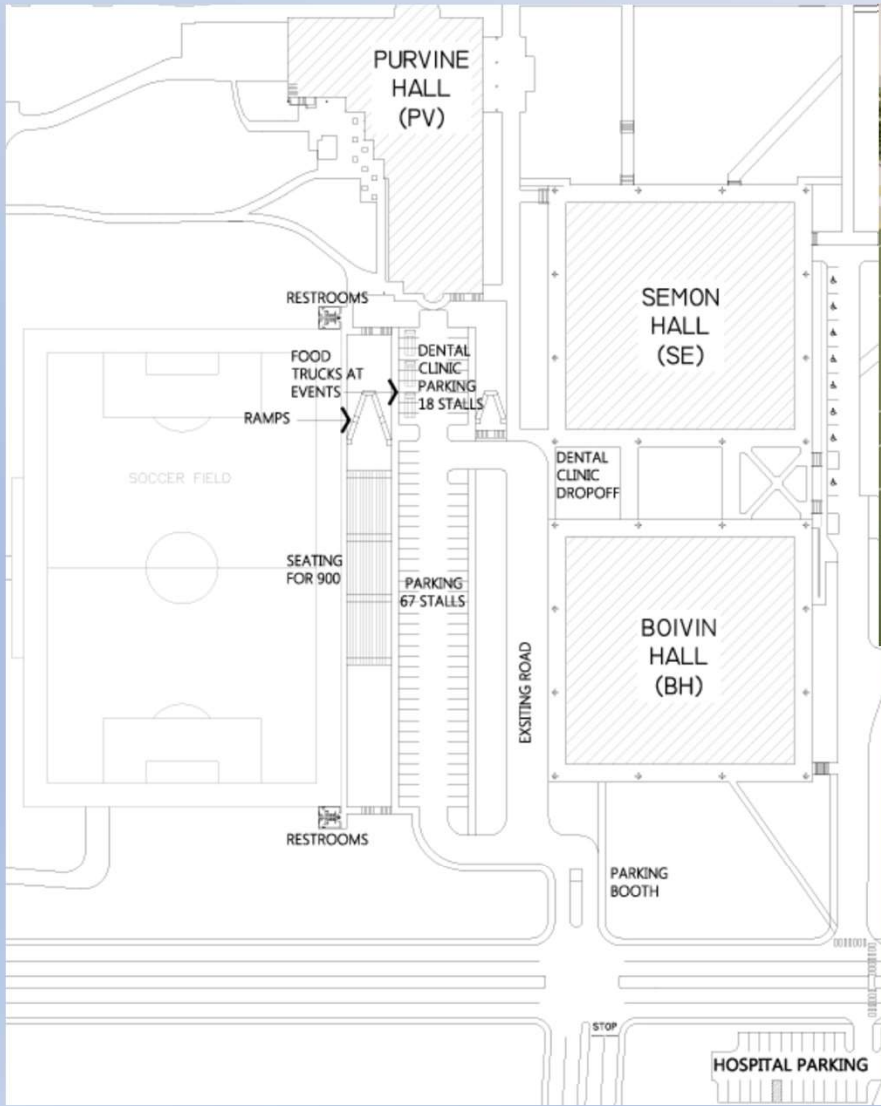







Enterprise Security Camera Technology Initiative

Background – Strategy - Timeline



Background

Emerging trends in campus safety have highlighted the need for Oregon Tech to consider developing a fully integrated, scalable and standardized enterprise-wide security camera technology platform.

Strategy

Initiative will support campus safety and enterprise risk mitigation strategies by enhancing the university's ability to monitor campus buildings and property, detect and prevent illicit activities, respond to adverse events and emergencies, protect the campus community and support post-event investigations.

Timeline

- RFP Launched: July 19, 2023
- RFP Closed: September 27, 2023
- RFP Review Committee Completion/Recommendation: November 3, 2023
- Project Initiation: December 2023



Enterprise Security Camera Technology Initiative

Scope of Work



Scope of Work

Selected vendor to provide a fully integrated and scalable cloud-based platform minimally consisting of a video management system, security camera technology, video storage solution and associated infrastructure.

- Capable of centralizing the university's security video management, viewing, recording and storage capabilities.
- Able to support, at a minimum, 750 cameras across all campuses.
- To be implemented as a phased, multi-year project inclusive of each university campus.
- Includes coverage of all interior pathways, public areas, foyers, IDF/MDF closet exteriors, the building exterior (adjacent open space/parking lots/walkways) and sensitive security areas.
- Turnkey solution that is capable of seamlessly interfacing with the university's current access management systems (5 system total).

Enterprise Security Camera Technology Initiative

Governance – Administration - Convergence



Governance

- Policy to govern the acquisition and use of physical security technologies.
- Procedures to guide employees in utilizing physical security technologies.
- Training for administrators and end users in the proper operation of physical security technologies.

Administration

- Establish structure to administer physical security technologies.
- Identify maintenance strategy to support physical security technologies functionality.

Convergence

- Integration of standardized physical security technologies into a common framework.
- Distinct physical security technologies (i.e., access control, fire/intrusion alarms, security cameras, etc.) managed as a single system.

Other